

NOTES:

1. DRAWING FOR REFERENCE ONLY
2. ELECTRICAL INTERFACE NOT SHOWN - TBD
3. IDENTICAL MOUNTING INTERFACE FOUND ON BOTH INPUT AND OUTPUT END
4. OVERALL SYSTEM MASS - 6.25 LBS
5. ROTATING MASS:
 1. INPUT (1.75 LBS)
 2. OUTPUT (1.30 LBS)

REVISIONS			
REV	DESCRIPTION	DATE	APPD
AA	RELEASE FOR REVIEW	9/16/08	
AB	UPDATE FOR MANUFACTURE	1/16/09	
00	RELEASE TO POWERWAY	6/19/09	

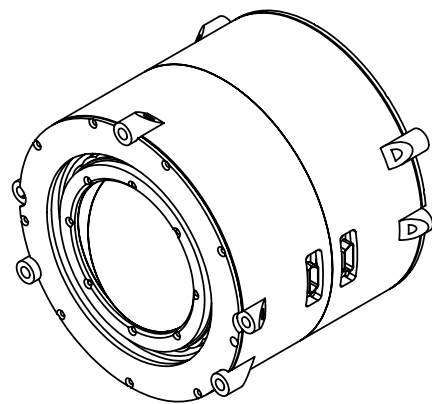
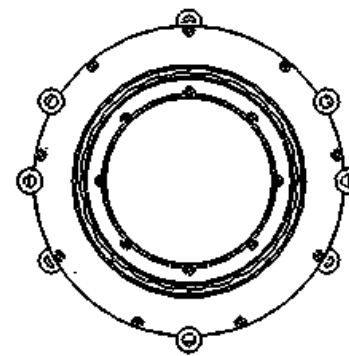
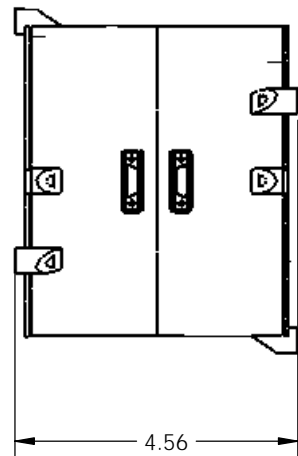
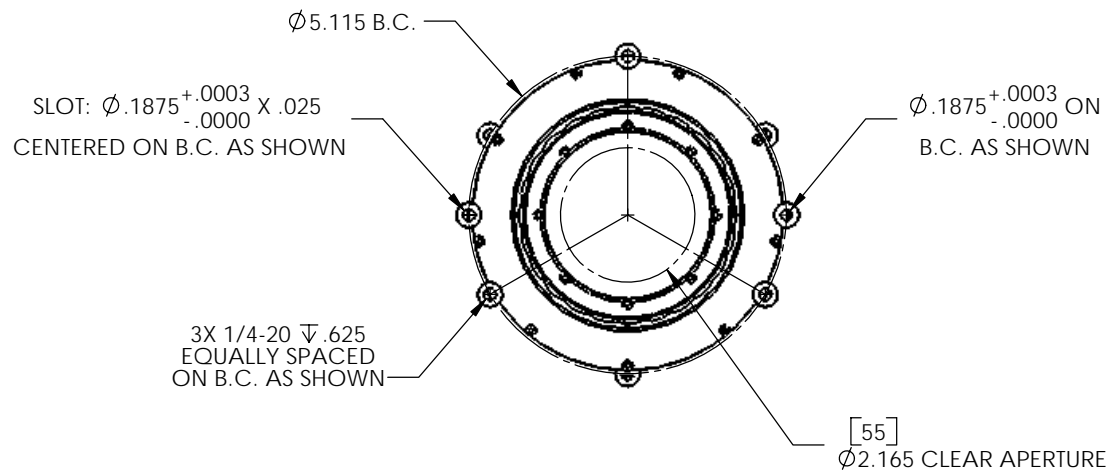

NOTICE: THIS DOCUMENT CONTAINS CONFIDENTIAL PROPRIETARY INFORMATION THAT IS OPTRA PROPERTY. DO NOT DISCLOSE TO OR DUPLICATE FOR OTHERS EXCEPT AS AUTHORIZED BY OPTRA.

X-XXXX-X	RP-50
NEXT ASSY	USED ON
APPLICATION	See Parts List
MATERIAL	See Parts List
APP'DTJE	07/25/08

UNLESS OTHERWISE SPECIFIED DIMENSIONS ARE IN INCHES
 TOLERANCES ARE:
 INCHES: X.XXX ± .030 mm: X ± .030
 X.XX ± .010 X.X ± .010
 X.XXX ± .005 X.XX ± .005
 ANGLES: X ± 2
 SURFACE: $\sqrt{32}$
 REMOVE BURRS AND BREAK ALL SHARP EDGES
 DO NOT SCALE FROM PRINT

OPTRA 461 BOSTON ST. TOPSFIELD, MA 01983 (978) 887-6600

TITLE: Mechanical Interface Drawing, RP-50

SIZE: C DRAWING NO.: 1-1462-3 REV: 00

SCALE: 1:2 SHEET 1 OF 1